



# NORTHFIELD CORPORATION

O.E.M. OF NORTHFIELD CONTINUOUS FEED COUPON INSERTERS

## Universal 2D/3D Coupon Inserter



### Featuring:

- Complete parts inventory on all equipment
- Service technicians available 24 hours a day, 7 days a week.
- Over 25 years experience worldwide with numerous companies, both large and small
- In-field consultation

Dedicated to efficient installation, service, and sales of pressure sensitive labelers, coupon inserting equipment, and neck hanger/ElastiTag® applicators which ensures that the correct equipment is used for every job, every time.

# NORTHFIELD UNIVERSAL INSERTER

## Continuous Feed Inserter Specifications:

Power Requirements: 115/230 VAC filtered, 50-60 cycles, 5 amps.

Max Speed: Up to 400+ pieces per minute  
\*Dependent on insert size and product

Linear Speed, In-Feed: Up to 7,000 I.P.M.

Linear Speed, Out-Feed: Up to 7,000 I.P.M.

Controls: Applied Motion Products, Maple Systems

Controller Dimension: 16" High, 14" Wide, 6" Deep

Head Weight: 45 lbs.

Controller Weight: 34 lbs.

Lubrication Needs: None

Change Parts: None

Air Requirements: None



## Standard 2-D/3-D Insert Size and Specifications:

Minimum Insert Size: 1" Wide x 2" Long

Maximum Insert Size: 5" Wide x 10" Long

Insert Thickness: Up to 2 3/4"

Splices: Heat Seal Factory Splices Only

Burst Tensile Strength: 8-12 lbs. Recommended not to exceed 17 lbs.

Note: 3-D Insert Height Tolerance: +/- 1/8"

The Northfield Universal 2D/3D Inserter is capable of accurately inserting either 2D or 3D overwrapped, NX2Food, and perforated paper inserts. 2D inserts can be in roll or bandolier form. 3D inserts must be in bandolier form. Some of the application examples are: horizontal/vertical fillers, carton lines, open container lines, and hot melt on/in pack applications.

Insert examples: game pieces, sweepstakes, coupons, instructions, rebates, toys, liquid pouches, powder pouches, etc.

Dimensions, Head

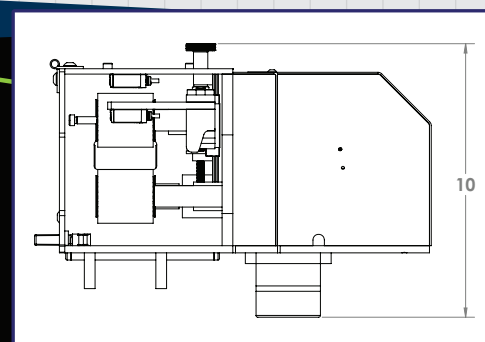
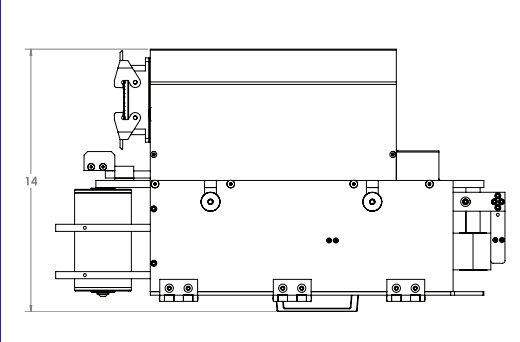
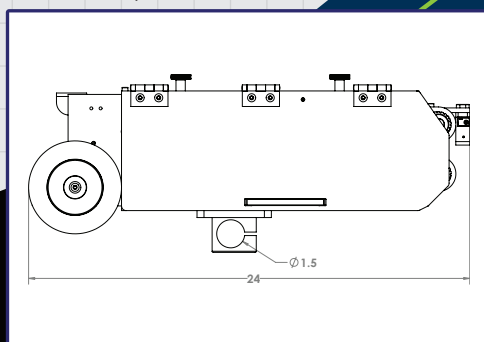

Distributed by:

## NORTHFIELD CORPORATION

1870 Commerce Drive • De Pere, WI 54115  
920-983-8122 • Fax 920-983-8124

[www.northfieldcorp.com](http://www.northfieldcorp.com)